

Quick guide

For full instructions please see Instructions for Use

Symbols and terms

On/off button

Yellow light at the battery warning symbol indicates that the battery needs to be recharged

Green light indicates that the monitoring is functioning in the correct way

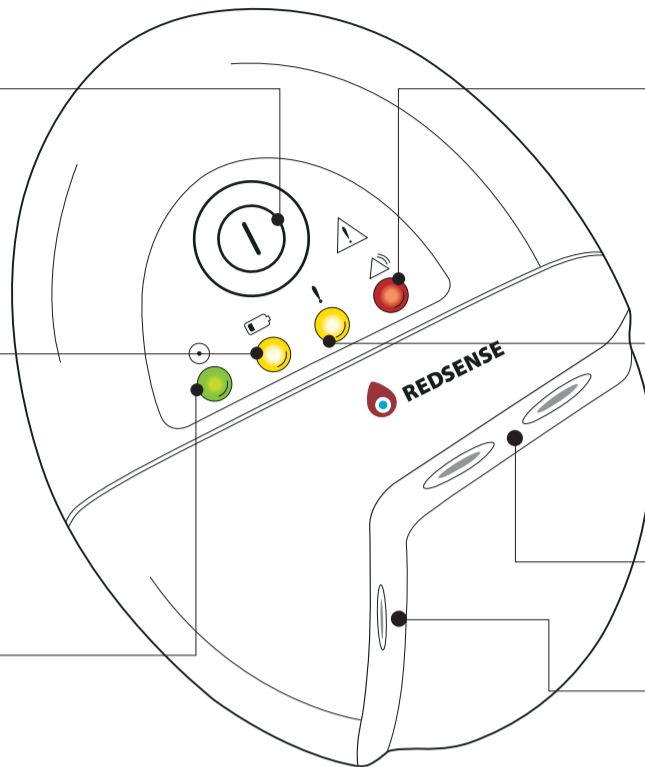

Red light and a continuous two-toned alarm signal indicate that blood has dripped onto the sensor either because the needle has been pulled out or there has been a leakage.

Yellow light at the exclamation mark indicates one of the following: Moisture has come into contact with the sensor. The sensor has come loose or broken down.

Socket for the sensor fiber optic cable

Socket for battery charger

Apply and connect

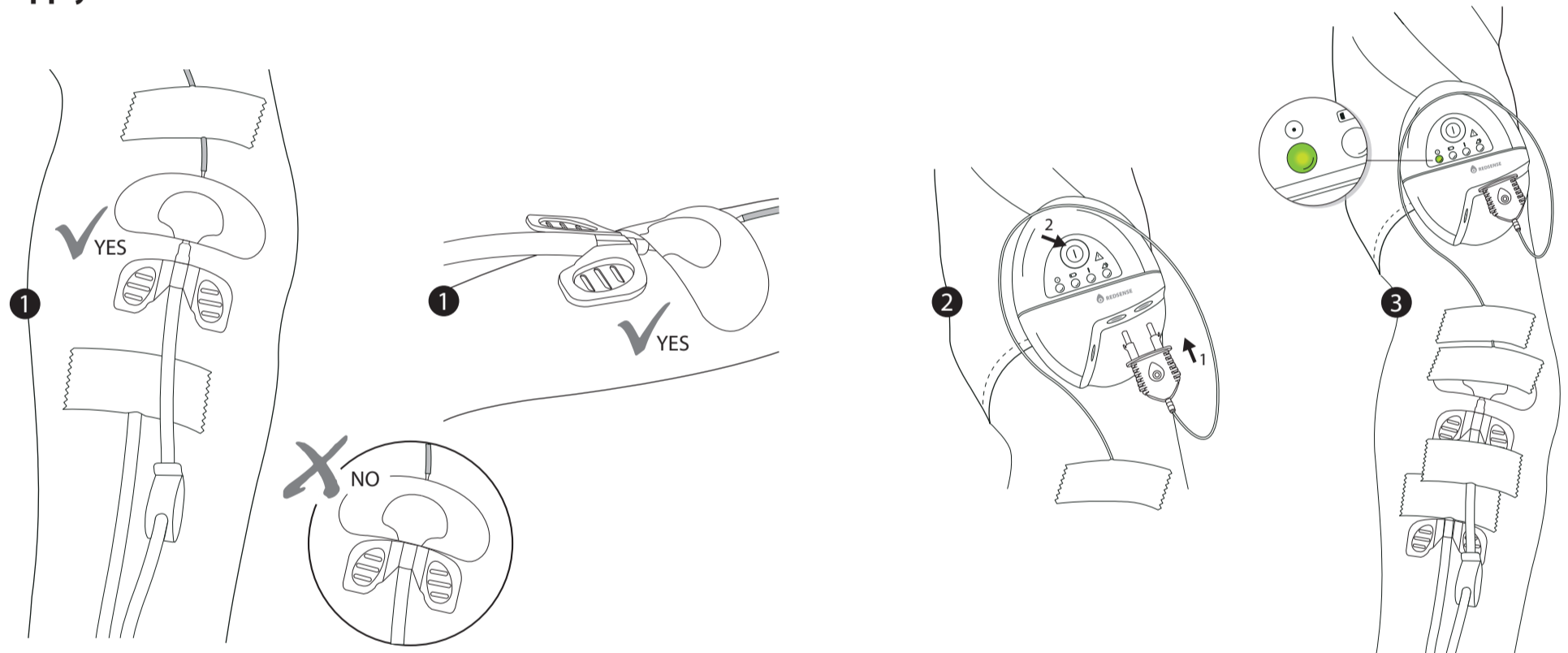

Fasten the alarm unit

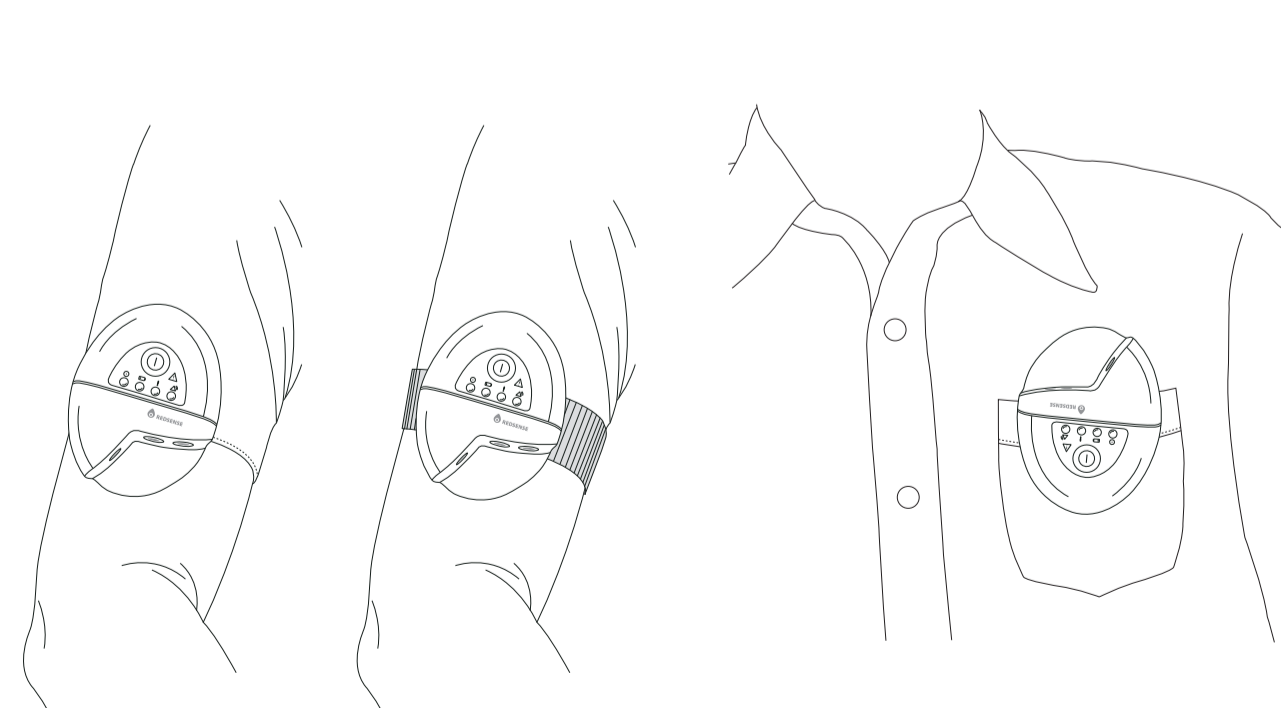

Charging

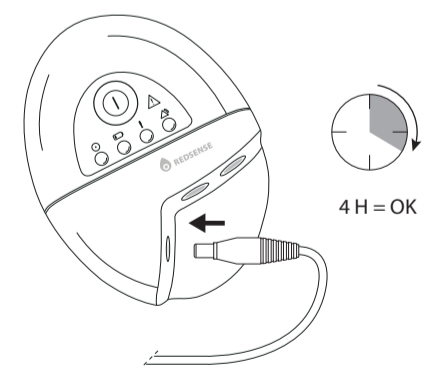

Printable surface

